

First Amendment
to Exhibit A
to the Facilities Lease
Between Miller Construction and Perris Union High School District

**GUARANTEED MAXIMUM PRICE, CONTINGENCY,
FINAL SCHEDULE MILESTONES, AND EXCLUSIONS**

The Facilities Lease between Paul C. Miller Construction Co., Inc. dba Miller Construction (“Miller”) and Perris Union High School District contemplates that the Parties will finalize a price, scope, and schedule within a document that will become Exhibit A thereto. The Parties previously approved a price, scope and schedule for Phase I – Demolition of Modular Units. The Parties now wish to amend their agreement to also include a price, scope and schedule for Phase II.

PHASE II : Campus Additions Project

Building L & M

- Auto Shop
- MPR / Culinary Arts

Building T

- Relocate Auto Shop
- Selective Demolition of Building T
- New Administration Building

Building A

- Relocate Administration
- Selective Demolition of Building A
- Construction New Student Center

The effectiveness of the provisions below are expressly conditioned on the District issuing a Notice to Proceed.

1. Scope

The following plans and specifications are included and incorporated herein by reference.

DSA Approved Application No. A04-120967 attached hereto as Attachment A

No work for which a contractor is required to be licensed in accordance with Article 5 (commencing with Section 7065) of Chapter 9 of Division 3 of the Business and Professions Code and for which Division of the State Architect approval is required can be performed before receipt of the required Division of the State Architect approval.

2. GMP and Contingencies

The Guaranteed Maximum Price (GMP) referenced in section 3.3 and elsewhere within the Facilities Lease for completion of all Work contemplated by **DSA Approved Application No. A04-120967** shall be **Fifty Million, Four Hundred and Thirty Two Thousand, Three Hundred Twenty and 39/100 Dollars (\$50,432,320.39)**.

The GMP summary is incorporated herein by refernced and attached as **Attachment B**.

The District Contingency referenced in section 3.3 and elsewhere within this Facilities Lease shall be **One Million, Six Hundred Ninety Nine Thousand, Eighty Two and 88/00 Dollars (\$1,699,082.88)** for this increment of work. The District Contingency shall be a line-item within the GMP. See **Attachment B, Page 1**.

3. Schedule

Phase 2

Project starts: October 21, 2024 (or upon issuance of a Notice to Proceed, whichever is later). If District does not provide a Notice to Proceed by October 21, 2024, then Miller shall be entitled to a time extension.

Substantial completion: November 21, 2025

Final completion: January 7, 2027

Milestone and Substantial Completion deadlines:

Failure to timely achieve Substantial Completion by November 21, 2025 or Final Completion by January 7, 2027 shall subject the contractor to liquidated damages as discussed in the Project Specific Conditions and Section 14.05 of the Project Manual.

The Phase 2 project schedule is attached hereto as Pages 2-6 of **Attachment B**.

[signatures on the following page]

IN WITNESS WHEREOF, the parties hereto have caused this First Amendment to Exhibit A of the Facilities Lease to be executed by their respective duly authorized officers, to be effective as of the day and year first written above.

PERRIS UNION HIGH SCHOOL DISTRICT, a school district organized and existing under the laws of the State of California

By: _____

Date: _____

PAUL C. MILLER CONSTRUCTION CO., INC. dba MILLER CONSTRUCTION, a California corporation

By: _____

Date: _____

Attachment A
Paloma Valley High School Plans and Specifications

Plans

https://drive.google.com/file/d/1SlaP8F1O-HJxDnP0zIjLGvtWirzs-b8_/view?usp=drive_link

Specifications

https://drive.google.com/file/d/1npVO0nC6TYs_w5t5HUZGfi0XNTfb0RRv/view?usp=drive_link

Attachment B



Paloma Valley High School - Campus Additions Project

GMP Summary

GMP Summary			GMP TOTALS	NOTES
HARD COST				
ITEM#		DESCRIPTION		
1		Category #00 - Demolition and Abatement	\$ 1,050,000.00	
2		Category #02 - Landscaping	\$ 728,000.00	
3		Category #03 - Concrete	\$ 7,845,423.00	
4		Category #04 - Masonry	\$ 441,000.00	
5		Category #05 - Structural Steel	\$ 2,860,300.00	
6		Category #06 - Rough Carpentry	\$ 1,580,470.00	
7		Category #07 - Gypsum, Plaster, and Insulation	\$ 2,844,086.00	
8		Category #08 - Casework	\$ 747,075.00	
9		Category #09 - Roofing & Sheetmetal	\$ 3,410,760.00	
11		Category #11 - Glass & Glazing	\$ 445,000.00	
12		Category #12 - Ceramic Tile	\$ 535,946.00	
13		Category #13 - Acoustic	\$ 336,480.00	
14		Category #14 - Flooring	\$ 512,103.00	
15		Category #15 - Painting	\$ 439,869.00	
16		Category #16 - Specialties	\$ 1,669,000.00	
17		Category #17 - HVAC	\$ 3,313,000.00	
18		Category #18 - Plumbing	\$ 2,953,000.00	
19		Category #19 - Electrical & Low Voltage	\$ 6,954,900.00	
20		Category #20 - Fire Sprinklers	\$ 584,000.00	
21		Category #21 - Doors & Hardware	\$ 671,350.00	
22		Category #22 - Fencing	\$ 370,600.00	
23		Category #23 - Kitchen Equipment	\$ 1,724,710.00	
			\$ (550,000.00)	Allowance Deduction (\$25k per Contractor)
24		Subcontractor Cost Total	\$ 41,467,072.00	
25		Contractor Performed Work	\$ 1,010,000.00	
	a	ROM for Backwash Tank	\$ 100,000.00	

		GMP TOTALS	NOTES
GMP Summary			
HARD COST			
ITEM#	DESCRIPTION		
	b Surveying	\$ 175,000.00	
	c SWPPP Monitoring	\$ 75,000.00	
	d Storage Containers	\$ 60,000.00	
	e BIM Coordination	\$ 50,000.00	
	f Security	\$ 100,000.00	
	g Misc. Site Labor/Cleaning	\$ 200,000.00	
	h Equipment Rentals	\$ 150,000.00	
	i Laydown Yard Restoration	\$ 75,000.00	
	j Temp Water/Power	\$ 25,000.00	
26	Construction Cost Total	\$ 42,477,072.00	
27	General Conditions & General Requirements	\$ 2,761,009.68	6.50%
28	District Contingency	\$ 1,699,082.88	4.00%
29	Construction Subtotal	\$ 46,937,164.56	
30	Escalation Allowance	\$ 150,000.00	
31	Bonds and Insurance	\$ 1,173,429.11	2.50%
32	Lease/Lease Back Fee	\$ 2,171,726.72	4.50%
33	Miller GMP	\$ 50,432,320.39	

Financial Cost	
Estimated Financed Amount is anticipated to be less than five percent (5%) of the GMP over forty-two (42) months. State the Firm's proposed interest for this Project.	2.50%

Accessories / Optional Products/Modifications			
ITEM#	DESCRIPTION	UNIT	AMOUNT
1		EACH	
2		EACH	
3		EACH	
4		EACH	

ID	WBS	Task Name	Duration	Start	Finish	23	Qtr 3	Qtr 4	Qtr 1	Qtr 2	Qtr 3	Qtr 4	Qtr 1	Qtr 2	Qtr 3	Qtr 4	Qtr 1	Qtr 2	Qtr 3	Qtr 4	Qtr 1	Qtr 2	20
1	1	Paloma Valley HS - Campus Additions	833 days	Mon 10/23/23	Thu 1/17/27																		
2	1.1	Phase 1 (Buildings L & M)	386 days	Mon 10/23/23	Tue 4/22/25																		
3	1.1.1	Earthwork and Site Utilities	56 days	Mon 10/23/23	Thu 1/11/24																		
4	1.1.1.1	Survey OX Limits	1 day	Mon 10/23/23	Mon 10/23/23																		
5	1.1.1.2	Cut and Cap Existing Utilities	3 days	Tue 10/24/23	Thu 10/26/23																		
6	1.1.1.3	OX Building Pads	10 days	Fri 10/27/23	Thu 11/9/23																		
7	1.1.1.4	Rough Grading	5 days	Fri 11/10/23	Thu 11/16/23																		
8	1.1.1.5	Certify Pads	2 days	Fri 11/17/23	Mon 11/20/23																		
9	1.1.1.6	Site Sewer/Storm Drain/Gas	10 days	Tue 11/21/23	Tue 12/5/23																		
10	1.1.1.7	Install Grease Interceptor and Sewer Lift Station	10 days	Wed 12/6/23	Tue 12/19/23																		
11	1.1.1.8	Site Domestic/Fire Water	5 days	Wed 12/20/23	Wed 12/27/23																		
12	1.1.1.9	Site Electrical	10 days	Thu 12/28/23	Thu 1/11/24																		
13	1.1.2	Building M	330 days	Fri 1/12/24	Tue 4/22/25																		
14	1.1.2.1	Foundation/Structural Steel	127 days	Fri 1/12/24	Wed 7/10/24																		
15	1.1.2.1.1	Building Plumbing	15 days	Fri 1/12/24	Thu 2/1/24																		
16	1.1.2.1.2	Dig Footings	10 days	Fri 2/2/24	Thu 2/15/24																		
17	1.1.2.1.3	Bolt Template Delivery	0 days	Fri 2/2/24	Fri 2/2/24																		
18	1.1.2.1.4	Pad Footing Rebar	3 days	Fri 2/16/24	Tue 2/20/24																		
19	1.1.2.1.5	Pour Pad Footings	2 days	Wed 2/21/24	Thu 2/22/24																		
20	1.1.2.1.6	Install Steel Moment Frames	10 days	Fri 2/23/24	Thu 3/7/24																		
21	1.1.2.1.7	Install Footing/Grade Beam Rebar	15 days	Fri 3/8/24	Thu 3/28/24																		
22	1.1.2.1.8	Field Weld Rebar to Moment Frames	5 days	Fri 3/22/24	Thu 3/28/24																		
23	1.1.2.1.9	Pour Footings and Grade Beams	3 days	Fri 3/29/24	Tue 4/2/24																		
24	1.1.2.1.10	Under Slab Plumbing	10 days	Wed 4/3/24	Tue 4/16/24																		
25	1.1.2.1.11	Under Slab Electrical	10 days	Wed 4/17/24	Tue 4/30/24																		
26	1.1.2.1.12	Sand/Vapor Barrier	3 days	Wed 5/1/24	Fri 5/3/24																		
27	1.1.2.1.13	Slab Rebar	5 days	Mon 5/6/24	Fri 5/10/24																		
28	1.1.2.1.14	Pour and Cure Slab	7 days	Mon 5/13/24	Tue 5/21/24																		
29	1.1.2.1.15	Structural Steel Low Roof	7 days	Wed 5/22/24	Fri 5/31/24																		
30	1.1.2.1.16	Structural Steel Mid Roof	7 days	Mon 6/3/24	Tue 6/11/24																		
31	1.1.2.1.17	Structural Steel High Roof	10 days	Wed 6/12/24	Tue 6/25/24																		
32	1.1.2.1.18	Metal Decking	10 days	Wed 6/26/24	Wed 7/10/24																		
33	1.1.2.2	Building Exterior	160 days	Thu 7/11/24	Thu 2/20/25																		
34	1.1.2.2.1	Exterior Metal Stud Wall Framing	15 days	Thu 7/11/24	Wed 7/31/24																		
35	1.1.2.2.2	Exterior Parapet/Soffit Framing	15 days	Thu 8/1/24	Wed 8/21/24																		
36	1.1.2.2.3	Exterior Sheathing	10 days	Thu 8/22/24	Thu 9/5/24																		
37	1.1.2.2.4	Roof Curbs/Platforms/Hatches	10 days	Thu 8/22/24	Thu 9/5/24																		
38	1.1.2.2.5	Roof Insulation	7 days	Fri 9/6/24	Mon 9/16/24																		
39	1.1.2.2.6	Roofing	10 days	Tue 9/17/24	Mon 9/30/24																		
40	1.1.2.2.7	Aluminum Window Assemblies/Curtain Walls	15 days	Thu 8/22/24	Thu 9/12/24																		
41	1.1.2.2.8	HM Door Frames	5 days	Thu 8/22/24	Wed 8/28/24																		
42	1.1.2.2.9	Exterior Weather Barrier/Lath	15 days	Fri 9/13/24	Thu 10/3/24																		
43	1.1.2.2.10	Gypsum Plaster Assembly	20 days	Fri 10/4/24	Thu 10/31/24																		
44	1.1.2.2.11	Exterior HM Doors	5 days	Fri 11/1/24	Thu 11/7/24																		
45	1.1.2.2.12	Exterior Glazing	10 days	Fri 11/1/24	Thu 11/14/24																		
46	1.1.2.2.13	Concrete Around Building	15 days	Fri 11/15/24	Thu 12/5/24																		
47	1.1.2.2.14	Exterior Paint	10 days	Fri 12/6/24	Thu 12/19/24																		
48	1.1.2.2.15	Exterior Sheetmetal	20 days	Fri 12/20/24	Thu 1/16/25																		
49	1.1.2.2.16	Exterior Finishes	10 days	Fri 1/17/25	Thu 1/30/25																		
50	1.1.2.2.17	Landscaping	15 days	Fri 1/31/25	Thu 2/20/25																		
51	1.1.2.3	Building Interior	203 days	Thu 7/11/24	Tue 4/22/25																		
52	1.1.2.3.1	Fire Sprinkler Rough	7 days	Thu 7/11/24	Fri 7/19/24																		
53	1.1.2.3.2	Interior Metal Stud Wall Framing	17 days	Mon 7/22/24	Tue 8/13/24																		
54	1.1.2.3.3	Plumbing Rough	15 days	Wed 8/14/24	Wed 9/4/24																		
55	1.1.2.3.4	Electric Rough	15 days	Wed 8/14/24	Wed 9/4/24																		
56	1.1.2.3.5	HVAC Rough	17 days	Wed 8/21/24	Fri 9/13/24																		
57	1.1.2.3.6	Interior Soffit/Hard Lid Framing	10 days	Mon 9/16/24	Fri 9/27/24																		
58	1.1.2.3.7	Set Interior Door Frames	3 days	Thu 9/5/24	Mon 9/9/24																		
59	1.1.2.3.8	Insulation	4 days	Tue 9/24/24	Fri 9/27/24																		
60	1.1.2.3.9	Hang Drywall	13 days	Mon 9/30/24	Wed 10/16/24																		
61	1.1.2.3.10	Tape Drywall	20 days	Mon 10/14/24	Fri 11/8/24																		
62	1.1.2.3.11	Interior Paint	15 days	Mon 10/28/24	Fri 11/15/24																		
63	1.1.2.3.12	Ceramic Tile	20 days	Mon 11/4/24	Fri 11/29/24																		

MILLER CONSTRUCTION

Project: 2321-PVHS Campus Additions Preliminary Baseline Schedule
Date: Tue 10/3/23

Task: Milestone: Duration-only: Baseline: Baseline Summary: Slippage:

Split: Summary: Finish-only: Baseline Milestone:

ID	WBS	Task Name	Duration	Start	Finish	23	Qtr 3	Qtr 4	Qtr 1	Qtr 2	Qtr 3	Qtr 4	Qtr 1	Qtr 2	Qtr 3	Qtr 4	Qtr 1	Qtr 2	Qtr 3	Qtr 4	Qtr 1	Qtr 2	
64	1.1.2.3.13	Polished Concrete Floor	15 days	Mon 11/18/24	Fri 12/6/24																		
65	1.1.2.3.14	Install Kitchen Exhaust Hoods	10 days	Mon 11/18/24	Fri 11/29/24																		
66	1.1.2.3.15	Install T-Bar Grid	5 days	Mon 12/2/24	Fri 12/6/24																		
67	1.1.2.3.16	Install Lights	10 days	Mon 12/9/24	Fri 12/20/24																		
68	1.1.2.3.17	Casework	10 days	Mon 12/9/24	Fri 12/20/24																		
69	1.1.2.3.18	Resinous Flooring	7 days	Mon 12/23/24	Tue 12/31/24																		
70	1.1.2.3.19	Install Coolers	5 days	Wed 1/1/25	Tue 1/7/25																		
71	1.1.2.3.20	Kitchen Equipment	25 days	Wed 1/8/25	Tue 2/11/25																		
72	1.1.2.3.21	Metal Lockers	5 days	Wed 2/12/25	Tue 2/18/25																		
73	1.1.2.3.22	Plumbing Finish	12 days	Wed 2/12/25	Thu 2/27/25																		
74	1.1.2.3.23	Electrical Finish	10 days	Wed 2/12/25	Tue 2/25/25																		
75	1.1.2.3.24	Interior Doors/Hardware	5 days	Wed 2/19/25	Tue 2/25/25																		
76	1.1.2.3.25	HVAC/Fire Sprinkler Finish	5 days	Wed 2/26/25	Tue 3/4/25																		
77	1.1.2.3.26	Air Balance	5 days	Wed 3/5/25	Tue 3/11/25																		
78	1.1.2.3.27	Fire Alarm Test	2 days	Wed 3/12/25	Thu 3/13/25																		
79	1.1.2.3.28	Final Cleaning	4 days	Fri 3/14/25	Wed 3/19/25																		
80	1.1.2.3.29	Health Department Inspection	2 days	Thu 3/20/25	Fri 3/21/25																		
81	1.1.2.3.30	Punch Walk	2 days	Mon 3/24/25	Tue 3/25/25																		
82	1.1.2.3.31	Complete Punch List	15 days	Wed 3/26/25	Tue 4/15/25																		
83	1.1.2.3.32	System Training	5 days	Wed 4/16/25	Tue 4/22/25																		
84	1.1.3	Building I	274 days	Mon 10/23/23	Fri 11/15/24																		
85	1.1.3.1	Foundation/CMU/Structural Steel	91 days	Fri 2/2/24	Mon 6/10/24																		
86	1.1.3.1.1	Building Plumbing	5 days	Fri 2/2/24	Thu 2/8/24																		
87	1.1.3.1.2	Dig Footings	5 days	Fri 2/16/24	Thu 2/22/24																		
88	1.1.3.1.3	Install Footing Rebar/Templates	5 days	Fri 2/23/24	Thu 2/29/24																		
89	1.1.3.1.4	Pour Footings	3 days	Fri 3/1/24	Tue 3/5/24																		
90	1.1.3.1.5	CMU Starter Courses	5 days	Wed 3/6/24	Tue 3/12/24																		
91	1.1.3.1.6	Under Slab Plumbing	4 days	Wed 3/13/24	Mon 3/18/24																		
92	1.1.3.1.7	Under Slab Electrical	5 days	Tue 3/19/24	Mon 3/25/24																		
93	1.1.3.1.8	Sand/Vapor Barrier	3 days	Tue 3/26/24	Thu 3/28/24																		
94	1.1.3.1.9	Slab Rebar	2 days	Fri 3/29/24	Mon 4/1/24																		
95	1.1.3.1.10	Pour/Cure Slab	7 days	Tue 4/2/24	Wed 4/10/24																		
96	1.1.3.1.11	CMU Walls	20 days	Thu 4/11/24	Wed 5/8/24																		
97	1.1.3.1.12	Structural Steel	10 days	Thu 5/9/24	Wed 5/22/24																		
98	1.1.3.1.13	Metal Decking	7 days	Thu 5/23/24	Mon 6/3/24																		
99	1.1.3.1.14	Concrete Roof Curbs	5 days	Tue 6/4/24	Mon 6/10/24																		
100	1.1.3.2	Building Exterior	100 days	Tue 6/4/24	Wed 10/23/24																		
101	1.1.3.2.1	Exterior Metal Stud Framing	10 days	Tue 6/4/24	Mon 6/17/24																		
102	1.1.3.2.2	Exterior Soffit Framing	5 days	Tue 6/18/24	Mon 6/24/24																		
103	1.1.3.2.3	Exterior Sheathing	5 days	Tue 6/25/24	Mon 7/1/24																		
104	1.1.3.2.4	Install HM Doors/Windows	3 days	Tue 7/2/24	Fri 7/5/24																		
105	1.1.3.2.5	Roof Curbs/Platforms/Hatches	5 days	Tue 7/2/24	Tue 7/9/24																		
106	1.1.3.2.6	Roof Insulation	5 days	Wed 7/10/24	Tue 7/16/24																		
107	1.1.3.2.7	Roofing	10 days	Wed 7/17/24	Tue 7/30/24																		
108	1.1.3.2.8	Exterior Weather Barrier/Lath	10 days	Tue 7/2/24	Tue 7/16/24																		
109	1.1.3.2.9	Gypsum Plaster Assembly	20 days	Wed 7/17/24	Tue 8/13/24																		
110	1.1.3.2.10	Exterior Doors and Glazing	5 days	Wed 8/14/24	Tue 8/20/24																		
111	1.1.3.2.11	Curbs/Concrete Around Building	20 days	Wed 8/21/24	Wed 9/18/24																		
112	1.1.3.2.12	Asphalt Paving	5 days	Thu 9/19/24	Wed 9/25/24																		
113	1.1.3.2.13	Exterior Paint	10 days	Thu 9/19/24	Wed 10/2/24																		
114	1.1.3.2.14	Sheet Metal	5 days	Thu 10/3/24	Wed 10/9/24																		
115	1.1.3.2.15	Site Gates and Hardware	10 days	Thu 10/3/24	Wed 10/16/24																		
116	1.1.3.2.16	Landscaping	15 days	Thu 10/3/24	Wed 10/23/24																		
117	1.1.3.3	Building Interior	274 days	Mon 10/23/23	Fri 11/15/24																		
118	1.1.3.3.1	Initial Concrete Polished Floor Grind	7 days	Mon 10/23/23	Tue 10/31/23																		
119	1.1.3.3.2	Fire Sprinkler Rough	5 days	Tue 6/4/24	Mon 6/10/24																		
120	1.1.3.3.3	Metal Stud Framing	10 days	Tue 6/11/24	Mon 6/24/24																		
121	1.1.3.3.4	Plumbing Rough	8 days	Tue 6/25/24	Fri 7/5/24																		
122	1.1.3.3.5	Electrical Rough	10 days	Mon 7/8/24	Fri 7/19/24																		
123	1.1.3.3.6	HVAC Rough	8 days	Mon 7/22/24	Wed 7/31/24																		
124	1.1.3.3.7	Metal Stud Ceilings	5 days	Thu 8/1/24	Wed 8/7/24																		
125	1.1.3.3.8	Insulation	2 days	Thu 8/8/24	Fri 8/9/24																		
126	1.1.3.3.9	Hang Drywall	5 days	Mon 8/12/24	Fri 8/16/24																		
127	1.1.3.3.10	Tape Drywall	10 days	Mon 8/19/24	Fri 8/30/24																		

MILLER CONSTRUCTION

Project: 2321-PVHS Campus Additions Preliminary Baseline Schedule
Date: Tue 10/3/23

Task Milestone Duration-only Baseline Baseline Summary

Split Summary Finish-only Baseline Milestone Slippage

ID	WBS	Task Name	Duration	Start	Finish	2024				2025				2026				20					
						Qtr 3	Qtr 4	Qtr 1	Qtr 2	Qtr 3	Qtr 4	Qtr 1	Qtr 2	Qtr 3	Qtr 4	Qtr 1	Qtr 2						
128	1.1.3.3.11	Interior Paint	13 days	Tue 9/3/24	Thu 9/19/24																		
129	1.1.3.3.12	Roll Up Doors	7 days	Fri 9/20/24	Mon 9/30/24																		
130	1.1.3.3.13	Ceramic Tile	10 days	Fri 9/6/24	Thu 9/19/24																		
131	1.1.3.3.14	Final Floor Grind/Polish	5 days	Fri 9/20/24	Thu 9/26/24																		
132	1.1.3.3.15	Plumbing Finish	10 days	Fri 9/27/24	Thu 10/10/24																		
133	1.1.3.3.16	Electrical Finish	10 days	Fri 9/27/24	Thu 10/10/24																		
134	1.1.3.3.17	HVAC Finish	5 days	Fri 10/4/24	Thu 10/10/24																		
135	1.1.3.3.18	Install Metal Lockers	5 days	Fri 10/11/24	Thu 10/17/24																		
136	1.1.3.3.19	Install Vehicle Lifts/Equipment	10 days	Fri 10/18/24	Thu 10/31/24																		
137	1.1.3.3.20	Interior Doors and Hardware	5 days	Fri 10/18/24	Thu 10/24/24																		
138	1.1.3.3.21	Air Balance	2 days	Fri 10/25/24	Mon 10/28/24																		
139	1.1.3.3.22	Fire Alarm Test	1 day	Tue 10/29/24	Tue 10/29/24																		
140	1.1.3.3.23	Final Cleaning	2 days	Wed 10/30/24	Thu 10/31/24																		
141	1.1.3.3.24	Punch Walk	1 day	Fri 11/1/24	Fri 11/1/24																		
142	1.1.3.3.25	Complete Punch List	10 days	Mon 11/4/24	Fri 11/15/24																		
143	1.2	Phase 2 (Building T)	285 days	Mon 11/18/24	Fri 12/19/25																		
144	1.2.1	Demolition/Foundation	70 days	Mon 11/18/24	Fri 2/23/25																		
145	1.2.1.1	Selective Building Demolition	20 days	Mon 11/18/24	Fri 12/13/24																		
146	1.2.1.2	Dig New Footings	8 days	Mon 12/16/24	Wed 12/25/24																		
147	1.2.1.3	Footing Rebar	4 days	Thu 12/26/24	Tue 12/31/24																		
148	1.2.1.4	Pour Footings	3 days	Wed 1/1/25	Fri 1/3/25																		
149	1.2.1.5	Building Underground Plumbing	10 days	Mon 12/23/24	Fri 1/3/25																		
150	1.2.1.6	Under Slab Electrical	10 days	Mon 1/6/25	Fri 1/17/25																		
151	1.2.1.7	Sand/Vapor Barrier	4 days	Mon 1/20/25	Thu 1/23/25																		
152	1.2.1.8	Slab Rebar	4 days	Fri 1/24/25	Wed 1/29/25																		
153	1.2.1.9	Pour/Cure Slab	7 days	Thu 1/30/25	Fri 2/7/25																		
154	1.2.1.10	Initial Polished Floor Grind	10 days	Mon 2/10/25	Fri 2/21/25																		
155	1.2.2	Structural Improvements	55 days	Mon 2/24/25	Fri 5/9/25																		
156	1.2.2.1	Structural Steel	5 days	Mon 2/24/25	Fri 2/28/25																		
157	1.2.2.2	Interior/Exterior Sheer Wall Framing	15 days	Mon 3/3/25	Fri 3/21/25																		
158	1.2.2.3	Roof Framing	15 days	Mon 3/24/25	Fri 4/11/25																		
159	1.2.2.4	Roof Sheathing	10 days	Mon 4/14/25	Fri 4/25/25																		
160	1.2.2.5	Exterior Soffit Framing/Sheathing	10 days	Mon 4/28/25	Fri 5/9/25																		
161	1.2.3	Building Exterior	110 days	Mon 4/28/25	Fri 9/26/25																		
162	1.2.3.1	Roof Curbs/Platforms/Access Hatches	10 days	Mon 4/28/25	Fri 5/9/25																		
163	1.2.3.2	Roof Insulation	5 days	Mon 4/28/25	Fri 5/2/25																		
164	1.2.3.3	Roofing	10 days	Mon 5/5/25	Fri 5/16/25																		
165	1.2.3.4	Install Exterior HM Frames	5 days	Mon 5/12/25	Fri 5/16/25																		
166	1.2.3.5	Install Aluminum Window Assemblies	10 days	Mon 5/12/25	Fri 5/23/25																		
167	1.2.3.6	Exterior Weather Barriers/Lath	15 days	Mon 5/26/25	Fri 6/13/25																		
168	1.2.3.7	Exterior Gypsum Plaster System	20 days	Mon 6/16/25	Fri 7/11/25																		
169	1.2.3.8	Concrete Around Building	15 days	Mon 7/14/25	Fri 8/1/25																		
170	1.2.3.9	Exterior Paint	10 days	Mon 8/4/25	Fri 8/15/25																		
171	1.2.3.10	Exterior Sheet Metal	20 days	Mon 8/18/25	Fri 9/12/25																		
172	1.2.3.11	Exterior Finishes	10 days	Mon 9/15/25	Fri 9/26/25																		
173	1.2.4	Building Interior	250 days	Mon 1/6/25	Fri 12/19/25																		
174	1.2.4.1	GL's 1-4	162 days	Mon 1/6/25	Tue 8/19/25																		
175	1.2.4.1.1	Two Hour Wall Separation	20 days	Mon 1/6/25	Fri 1/31/25																		
176	1.2.4.1.2	Interior Metal Stud Framing	10 days	Mon 2/24/25	Fri 3/7/25																		
177	1.2.4.1.3	Plumbing Rough	7 days	Mon 3/10/25	Tue 3/18/25																		
178	1.2.4.1.4	Electrical Rough	15 days	Mon 3/10/25	Fri 3/28/25																		
179	1.2.4.1.5	Fire Sprinkler Rough	5 days	Wed 3/19/25	Tue 3/25/25																		
180	1.2.4.1.6	HVAC Rough	15 days	Wed 3/26/25	Tue 4/15/25																		
181	1.2.4.1.7	Insulation	3 days	Wed 4/16/25	Fri 4/18/25																		
182	1.2.4.1.8	Interior Door Jambs	3 days	Wed 4/16/25	Fri 4/18/25																		
183	1.2.4.1.9	Hang Drywall	10 days	Mon 4/21/25	Fri 5/2/25																		
184	1.2.4.1.10	Tape Drywall	15 days	Mon 5/5/25	Fri 5/23/25																		
185	1.2.4.1.11	Interior Paint	10 days	Mon 5/26/25	Fri 6/6/25																		
186	1.2.4.1.12	Dry Erase Wall Coverings	5 days	Mon 6/9/25	Fri 6/13/25																		
187	1.2.4.1.13	T-Bar Grid	7 days	Mon 6/16/25	Tue 6/24/25																		
188	1.2.4.1.14	Install Lights	7 days	Wed 6/25/25	Thu 7/3/25																		
189	1.2.4.1.15	Final Floor Grind/Polish	5 days	Fri 7/4/25	Thu 7/10/25																		
190	1.2.4.1.16	Ceramic Tile	10 days	Fri 7/11/25	Thu 7/24/25																		
191	1.2.4.1.17	Tile Carpeting	8 days	Fri 7/11/25	Tue 7/22/25																		

MILLER CONSTRUCTION
Project: 2321-PVHS Campus Additions Preliminary Baseline Schedule
Date: Tue 10/3/23



ID	WBS	Task Name	Duration	Start	Finish	23	2024				2025				2026				20			
							Qtr 3	Qtr 4	Qtr 1	Qtr 2	Qtr 3	Qtr 4	Qtr 1	Qtr 2	Qtr 3	Qtr 4	Qtr 1	Qtr 2				
256	1.3.4.12	Hang Drywall	10 days	Tue 5/12/26	Mon 5/25/26																	
257	1.3.4.13	Patch/Tape Drywall	20 days	Tue 5/26/26	Mon 6/22/26																	
258	1.3.4.14	Interior Paint	15 days	Tue 6/16/26	Mon 7/6/26																	
259	1.3.4.15	Install Roll Up Door	3 days	Tue 7/7/26	Thu 7/9/26																	
260	1.3.4.16	Install Dry Erase Wall Coverings	5 days	Tue 7/7/26	Mon 7/13/26																	
261	1.3.4.17	T-Bar Grid	15 days	Tue 7/14/26	Mon 8/3/26																	
262	1.3.4.18	Install Lights	10 days	Tue 8/4/26	Mon 8/17/26																	
263	1.3.4.19	Ceramic Tile	15 days	Tue 6/23/26	Mon 7/13/26																	
264	1.3.4.20	Resinous Flooring	10 days	Tue 8/18/26	Mon 8/31/26																	
265	1.3.4.21	Install Casework	15 days	Tue 9/1/26	Mon 9/21/26																	
266	1.3.4.22	Plumbing Finish	15 days	Tue 9/22/26	Mon 10/12/26																	
267	1.3.4.23	Electrical/Low Voltage Finish	20 days	Tue 9/22/26	Mon 10/19/26																	
268	1.3.4.24	HVAC Finish	10 days	Tue 10/20/26	Mon 11/2/26																	
269	1.3.4.25	Ceiling Tiles	5 days	Tue 11/3/26	Mon 11/9/26																	
270	1.3.4.26	Interior Doors and Hardware	10 days	Tue 11/3/26	Mon 11/16/26																	
271	1.3.4.27	Tile Carpeting	15 days	Tue 11/17/26	Mon 12/7/26																	
272	1.3.4.28	Air Balance	5 days	Tue 12/8/26	Mon 12/14/26																	
273	1.3.4.29	Fire Alarm Test	2 days	Tue 12/15/26	Wed 12/16/26																	
274	1.3.4.30	Final Cleaning	5 days	Tue 12/8/26	Mon 12/14/26																	
275	1.3.4.31	Punch Walk	1 day	Thu 12/17/26	Thu 12/17/26																	
276	1.3.4.32	Complete Punch List	15 days	Fri 12/18/26	Thu 1/7/27																	
277	1.4	Student Parking Lot and Drop Off	302 days	Mon 7/7/25	Tue 9/1/26																	
278	1.4.1	Main Parking Area	42 days	Mon 7/7/25	Tue 9/2/25																	
279	1.4.1.1	Demo	9 days	Mon 7/7/25	Thu 7/17/25																	
280	1.4.1.2	Grading	8 days	Fri 7/18/25	Tue 7/29/25																	
281	1.4.1.3	Site Utilities	10 days	Wed 7/30/25	Tue 8/12/25																	
282	1.4.1.4	Site Lighting/Electrical	10 days	Wed 7/30/25	Tue 8/12/25																	
283	1.4.1.5	Fencing	15 days	Wed 7/30/25	Tue 8/19/25																	
284	1.4.1.6	Curb And Gutter	5 days	Wed 8/6/25	Tue 8/12/25																	
285	1.4.1.7	Side Walks	5 days	Wed 8/13/25	Tue 8/19/25																	
286	1.4.1.8	Asphalt Paving	5 days	Wed 8/20/25	Tue 8/26/25																	
287	1.4.1.9	Temp Striping	3 days	Wed 8/27/25	Fri 8/29/25																	
288	1.4.1.10	Clean Up	2 days	Mon 9/1/25	Tue 9/2/25																	
289	1.4.2	Guest Parking and Drop Off	42 days	Mon 7/6/26	Tue 9/1/26																	
290	1.4.2.1	Demo	8 days	Mon 7/6/26	Wed 7/15/26																	
291	1.4.2.2	Grading	7 days	Thu 7/16/26	Fri 7/24/26																	
292	1.4.2.3	Site Utilities	10 days	Mon 7/27/26	Fri 8/7/26																	
293	1.4.2.4	Site Lighting/Electrical	10 days	Mon 7/27/26	Fri 8/7/26																	
294	1.4.2.5	Fencing	10 days	Mon 7/27/26	Fri 8/7/26																	
295	1.4.2.6	Curb And Gutter	7 days	Mon 8/3/26	Tue 8/11/26																	
296	1.4.2.7	Side Walks	8 days	Wed 8/12/26	Fri 8/21/26																	
297	1.4.2.8	Asphalt Paving	5 days	Mon 8/24/26	Fri 8/28/26																	
298	1.4.2.9	Temp Striping	2 days	Mon 8/31/26	Tue 9/1/26																	
299	1.4.2.10	Clean Up	2 days	Mon 8/31/26	Tue 9/1/26																	

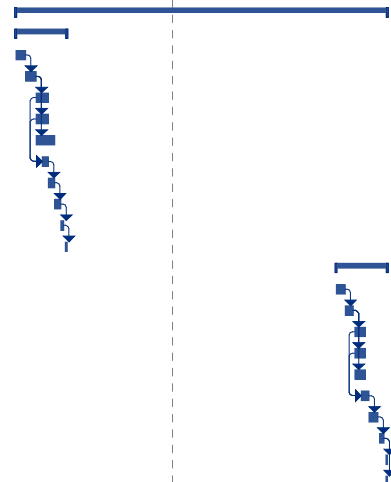

Task Milestone Duration-only Baseline Baseline Summary Slippage

Split Summary Finish-only Baseline Milestone

PALOMA VALLEY HIGH SCHOOL
Modernization Project

Construction Phasing Plan

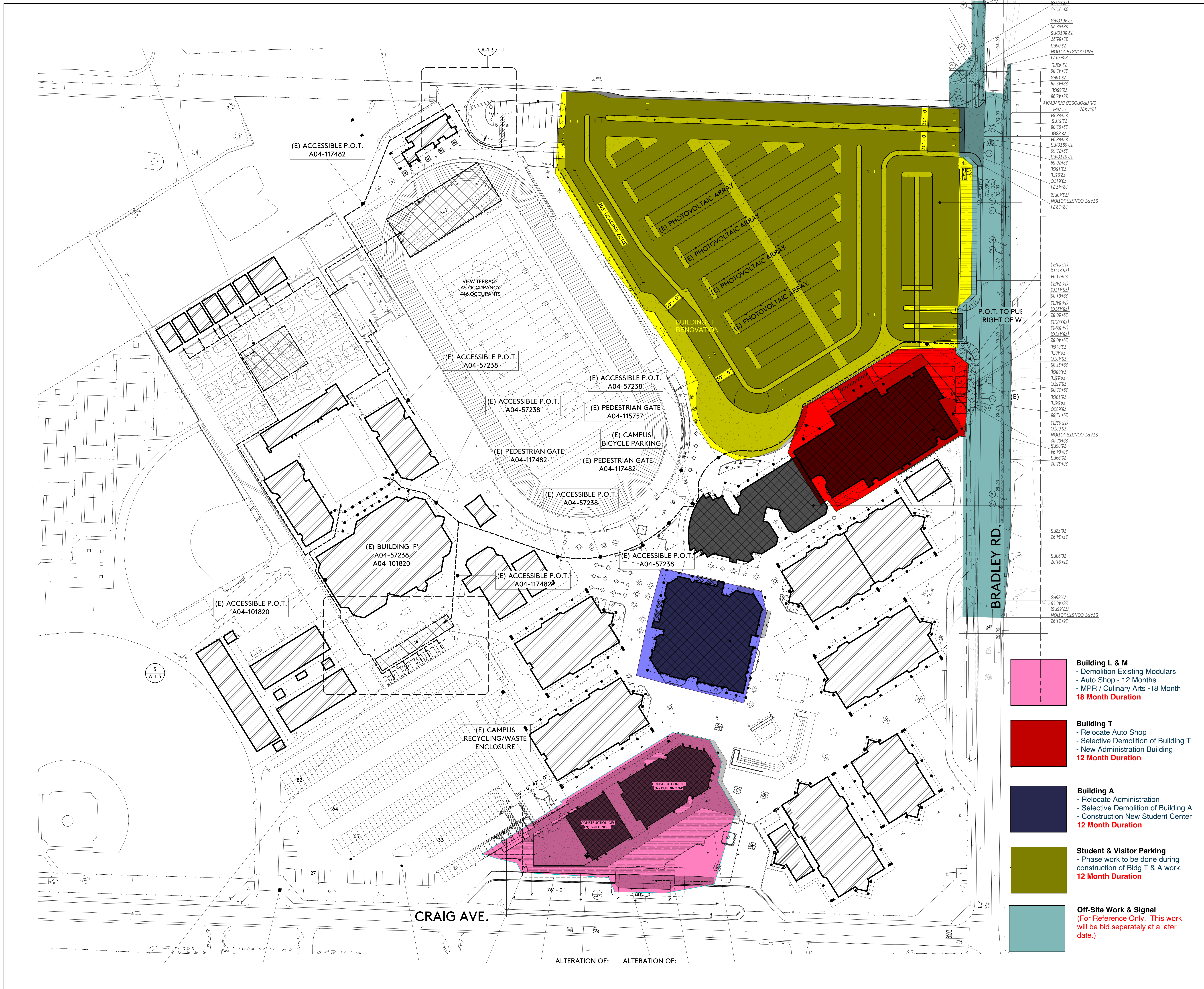

- Building L & M**
- Demolition Existing Modularity
- Auto Shop - 12 Months
- MPR / Culinary Arts - 18 Month
18 Month Duration
- Building T**
- Relocate Auto Shop
- Selective Demolition of Building T
- New Administration Building
12 Month Duration
- Building A**
- Relocate Administration
- Selective Demolition of Building A
- Construction New Student Center
12 Month Duration
- Student & Visitor Parking**
- Phase work to be done during construction of Bldg T & A work.
12 Month Duration
- Off-Site Work & Signal**
(For Reference Only. This work will be bid separately at a later date.)

Construction

Phasing

CP - 1.0